

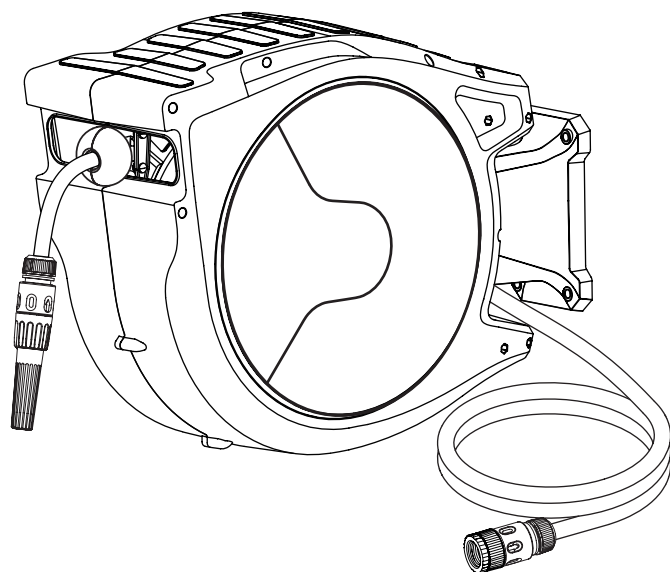

25m Retractable Hose Reel

Model: 50137389



Installation, Use & Maintenance Guide



WARNING: READ THE ENTIRE GUIDE BEFORE INSTALLATION OR USE.



WARNING: RELEASE WATER PRESSURE WHEN NOT IN USE.



WARNING: PRODUCT CONTAINS CHARGED SPRING. DO NOT DISASSEMBLE HOUSING.

CONTENTS

- A. Hose Reel
- B. Adjustable Nozzle
- C. Universal Tap Adaptor
- D. Hardware pack containing:
 - 4 x Screws
 - 4 x Washers
 - 4 x Wall Plugs
- E. Instruction Manual
- F. Mounting Bracket
- G. Mounting Pin

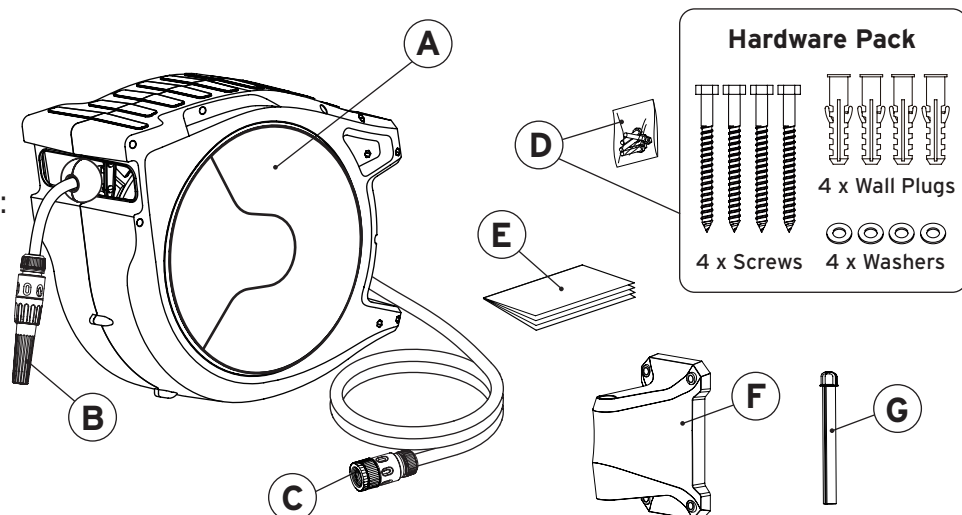

SPECIFICATIONS

Outlet Hose Length	Inlet Hose Length	Hose ID	Hose Fitting Size	Operating Pressure	Mounting Bracket	Country of Manufacture
25m	2m	10.7mm	12mm	Max 800 kPa	180° swivel	China

INSTALLING YOUR RETRACTABLE HOSE REEL

Choosing the best mounting location

This product can be mounted in many different ways. It is important to select your mounting location carefully. Considerations are:

1. This product includes 2m of inlet hose. Make sure it can reach your tap.
2. This product includes 25m of outlet hose. Make sure it can reach your garden.
3. Out of direct sunlight.
4. Strong enough to support the loads shown to the right (per screw). If unsure, contact a professional installer.
5. Refer to the installation options below for more detail.

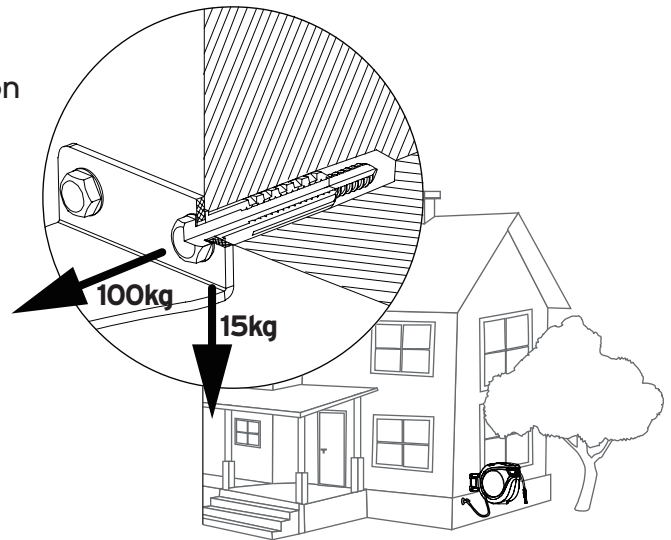

WARNING: IF NOT PROPERLY INSTALLED, THERE IS A RISK OF FALLING. ENSURE YOUR INSTALLATION CAN SUPPORT THE LOADS ABOVE.



CAUTION: WHEN USING TOOLS, PLEASE WEAR APPROPRIATE PPE.



WARNING: ENSURE THERE ARE NO LIVE ELECTRICAL WIRES OR PLUMBING IN THE WALL AT THE LOCATION YOU ARE DRILLING.

Direct Mount to Timber Post

Recommended tools

- masking tape
- graphite pencil
- spirit level
- electric drill
- Ø5mm drill bit
- hexagon socket with extension or Phillips head screw driver

Steps

1. Tape the bracket on the post at a convenient height and mark the holes with pencil.
2. Check the hole centers with the spirit level to ensure they are plumb.
3. Drill four holes with a Ø5mm drill bit at the marked locations.
4. Fasten the mounting bracket with four washers and screws to the timber post.
5. Hang the hose reel on the bracket and secure it by inserting the mounting pin.
6. Connect inlet hose to tap.

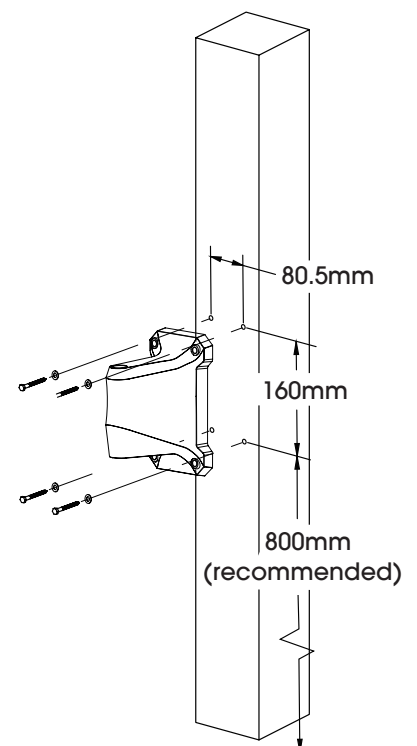

Mount to Hollow Wall or Masonry Wall

Recommended tools

- masking tape
- graphite pencil
- spirit level
- electric drill
- Ø10mm masonry drill bit
- hammer or mallet
- hexagon socket with extension or Phillips head screw driver

Steps

1. Tape the bracket on the wall at a convenient height and mark the holes with pencil.
2. Check the hole centers with the spirit level to ensure they are plumb.
3. Drill four holes with a Ø10mm masonry drill bit at the marked locations.
4. Tap plastic wall plugs into holes with a hammer or mallet.
5. Fasten the mounting bracket with four washers and screws to the wall ensuring the screws drive into the plastic wall plugs.
6. Hang the hose reel on the bracket and secure it by inserting the mounting pin.
7. Connect inlet hose to tap.

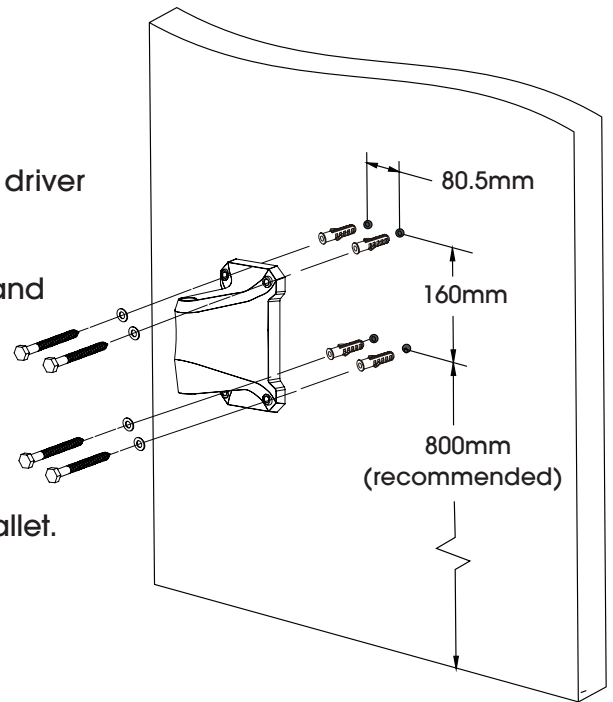

OPERATING INSTRUCTIONS



WARNING: ALWAYS HOLD THE HOSE UNTIL IT COMPLETELY RETRACTS INTO THE HOSE REEL. DO NOT ALLOW THE HOSE TO REWIND ON ITS OWN.



WARNING: RELEASE WATER PRESSURE WHEN NOT IN USE.



WARNING: DO NOT LOOK INTO THE END OF THE HOSE WHILE HOSE IS UNDER PRESSURE.

1. Pull the hose out to the desired length. The hose will automatically lock in position.
2. To unlock and retract, give the hose a short pull. Walk the hose back to the hose reel. If you pull the hose longer than 10cm you may re-lock the hose.
3. To avoid injury and damage, always hold the hose while it is retracting. This hose reel has a controlled return function.
4. If the hose becomes tangled and will not retract - slowly pull out the hose past the tangled section and then allow the hose to slowly retract while guiding the hose back into the reel. Always ensure the hose is clean and not twisted when retracting back into the unit.
5. Turn off tap and discharge water to ensure hose retracts all the way into the unit.

NOTE:

- The Retractable Hose Reel is designed for home watering applications using cold water only.
- This reel is not intended for drinking water.
- The yellow tape marks the end of the hose length.
- Extreme temperatures can affect the performance of the unit.

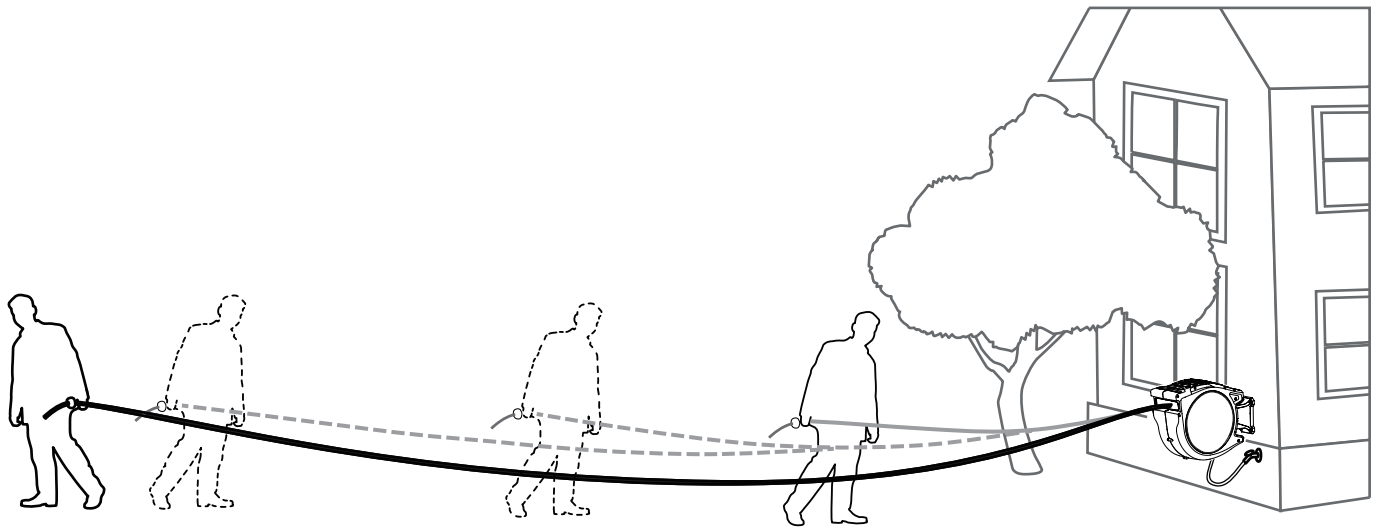

MAINTENANCE



WARNING: PRODUCT CONTAINS CHARGED SPRING. DO NOT DISASSEMBLE REEL CASING.

While your product has been made with UV stabilised materials, degradation can occur over time. Inspect the hose and reel periodically. If cracking or blisters are visible, discontinue use.

1. Always keep the hose clean. If the hose becomes dirty, clean it with a damp cloth while retracting.
2. Always walk the hose back to the unit. Allowing the hose to retract on its own can cause the hose to bunch up inside the unit and could damage the hose and fittings.
3. DO NOT twist the hose while in use.
4. Mount the hose reel in a sheltered area to help the longevity of your hose and reel.
5. DO NOT allow the hose to get in contact with any corrosive chemicals or fluids.
6. Always retract the hose when not in use.
7. Always turn off tap and discharge water after each use.

GUARANTEE

This Pope 25m Retractable Hose Reel has a 2 year guarantee from the date of purchase against defects in material and workmanship when used in normal home gardening applications. Our obligation under this guarantee is limited to the replacement of the product at our discretion. In the event of a claim, you must immediately cease using the product and return the product, together with your proof of purchase and an explanation of the fault to the store you purchased it from. All costs associated with the return of the product are your responsibility.

Our goods come with guarantees that cannot be excluded under the Australian Consumer Law. You are entitled to a replacement or refund for a major failure and for compensation for any other reasonably foreseeable loss or damage. You are also entitled to have the goods repaired or replaced if the goods fail to be of acceptable quality and the failure does not amount to a major failure. It is recommended to retain a photo of your receipt with this manual in the event of a warranty claim.

Should you have any trouble shooting issues with your reel, please call our Customer Experience Team on 1300 134 880.